

[illegible]

Technical drawing of a window frame detail. The drawing shows a cross-section of the frame with dimensions in millimeters (mm). The overall width is 6920 mm, and the overall height is 1360 mm. The frame is divided into three vertical sections: a left section of 54 mm, a middle section of 5450 mm, and a right section of 700 mm. The frame is reinforced with steel bars (spony) of diameter 6 mm (ø 6) and 12 mm (ø 12). The reinforcement is shown in the middle section, with the top bar labeled 'spony ø 6 (ø 8)' and the bottom bar labeled 'spony ø 12'. The frame is also shown with a 50 mm gap at the bottom. The drawing is labeled 'Detail uložení spon 1:10'.

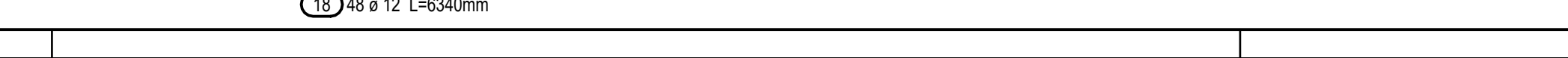
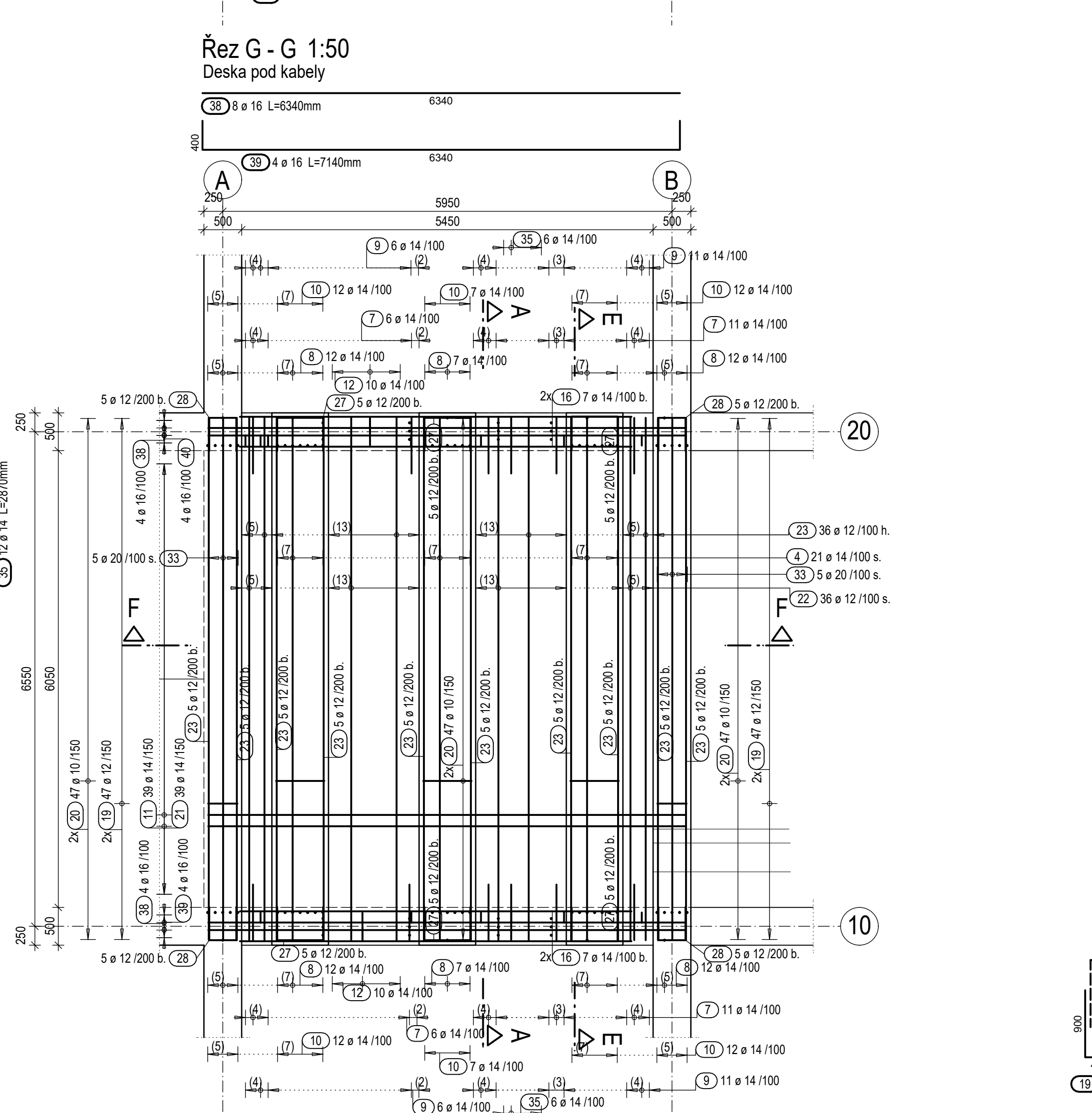
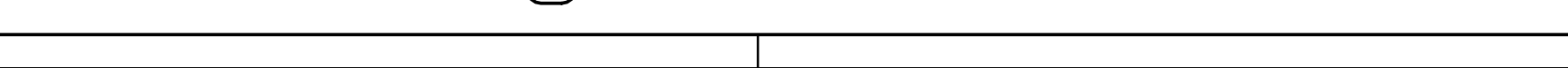